

Instruction Guide

Indications

- Aide/enhance knee brace suspension
- Limit knee brace rotation

Contraindications

- Persons with circulatory, pulmonary, cardiovascular and other conditions where increased pressure would be of concern.

Instructions for Care



- Hand wash cold with mild detergent
- Do not tumble
- Lay Flat to dry

Caution

This product has been designed and tested for single patient use. It is intended to be prescribed and fitted by a licensed medical professional. The patient must immediately discontinue use and contact their medical professional if:

- Any problems occur with the use of this product
- Any increased pain, swelling, numbing, skin irritation, or any other adverse reaction while using this product

The patient should consult with their medical professional before making any adjustments to the brace.

Warranty

Six Month Limited Warranty –Thuasne USA warrants to the original purchaser that this product is free from defects in materials and workmanship. Normal wear and tear during the use of a product is not considered a defect. This Limited Warranty is effective from the date of delivery to the original purchaser for up to 6 months. This warranty does not apply if this product; (1) has been altered in any way; (2) was not purchased from Thuasne USA or one of its authorized distributors; (3) is not used in accordance with Thuasne USA's Instructions for Use (IFU)

Fitting Instructions

1. Wrap around the center of the calf and secure with Velcro tab.
2. Apply Velcro strips to C/S Wrap making sure the placement of the strips match the positioning of the distal straps of the brace.
3. Fit brace over the C/S Wrap and confirm the proper placement of Velcro Strips.
4. Tighten straps, ensuring Velcro Strips are secured between the straps and the wrap.

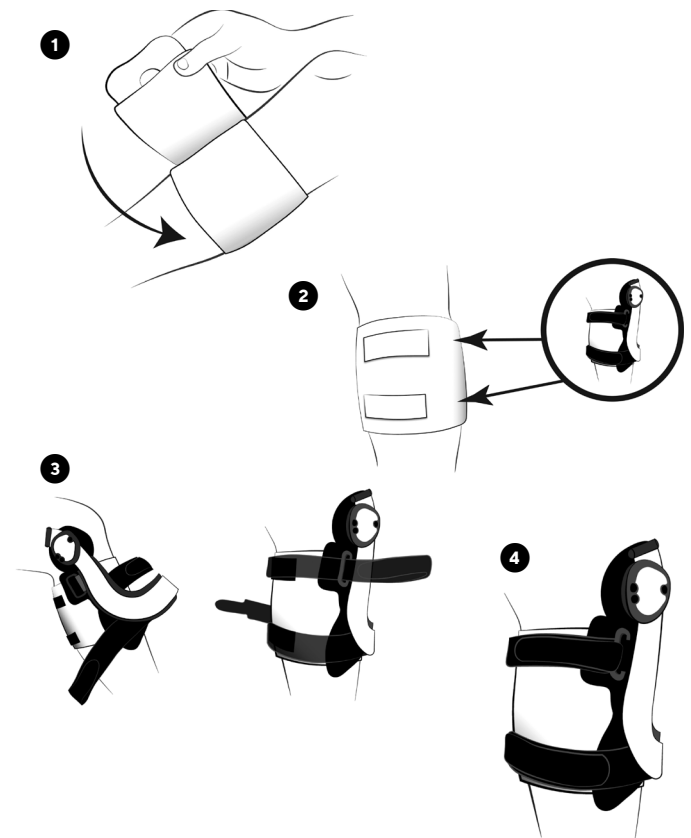

Distributed by
Thuasne USA

4615 Shepard Street,
Bakersfield, CA 93313
United States
Tele: 800.432.3466
Fax: 800.798.2722
ThuasneUSA.com

L-0156 REV. A