

## AeroSling Shoulder Immobilizer INSTRUCTIONS FOR USE

### Indications:

Shoulder stabilization, rotator cuff surgery, bankart surgery, joint separation, muscle strain, anterior, inferior, posterior instability.

### Application Instructions:

*(Illustrations for right shoulder; reverse for left shoulder)*

Form the rigid abduction band to the contour of the waist on the affected side, adjust the waist strap to the desired length and tension so that the device remains in place. Cut the excess material on the waist strap and re-attach the "Y" tab adapter. Leave plastic sleeve in place. **See images 1 & 2**

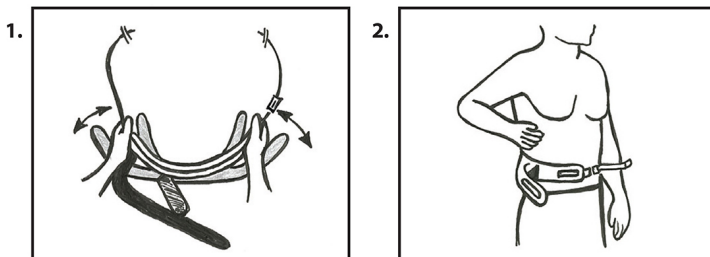

Remove the buckle assembly on the sling and the hook/loop elastic strap across the pocket opening to allow your arm to be inserted into the pocket of the sling. Position elbow to the back of the sling pocket and adjust the length of the sling pocket by folding the material back to first or second seam allowing the fingers to be exposed when sized correctly. **See images 3 & 4**

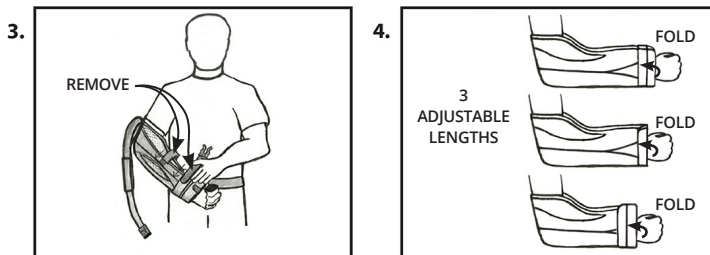

**Please read these instructions completely and carefully before applying this product.**

**Correct application is important for proper function of the brace.**

Place the sling pocket onto the rigid abduction band so that the fingers are directly over the movable portion of the torso assembly. Remove plastic sleeve and press sling onto Velcro arm support. **See images 5 & 6**

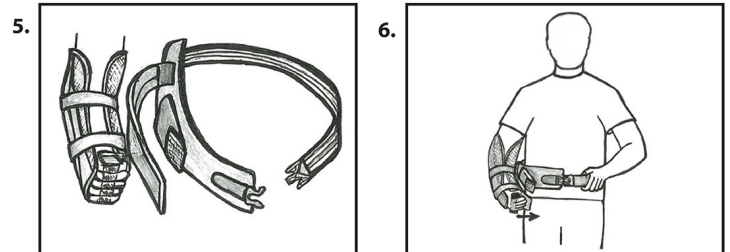

Pass the shoulder strap over the unaffected shoulder. Secure the strap with the buckle closure and adjust the length of the strap across the back for a comfortable fit. **See images 7, 8, 9**

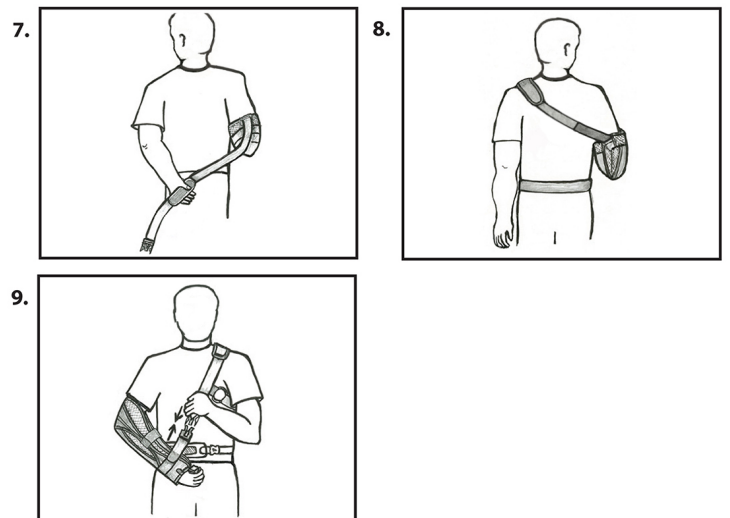

### Sling Only with Immobilizer Strap

Remove both sides of the waist belt assembly from the rigid abduction band. Affix the hook material to the inside edge of the sling pocket so that the buckle assembly is directly adjacent to the finger opening portion of the sling. Adjust waist belt for length and trim excess material. **See Image 10, 11, & 12**

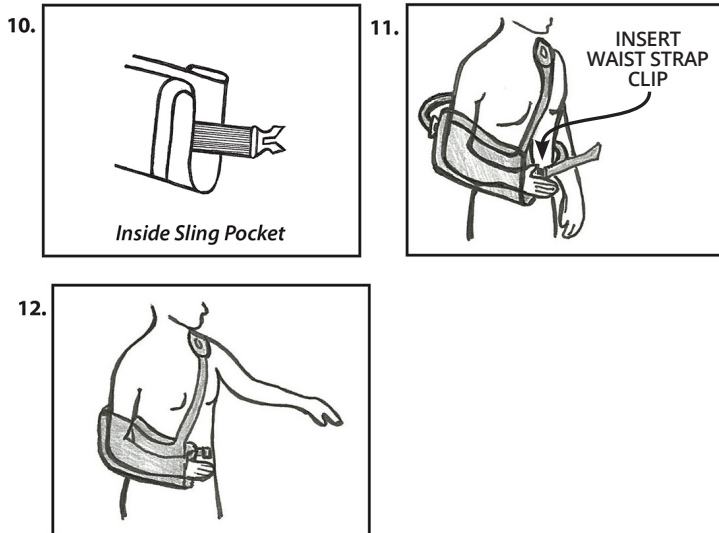

### Adjust Rotation of the Rigid Device

Internal, neutral, and external rotation can be accomplished by adjusting the flexible portion of the rigid abduction band.

Adjust flat (internal), partially extended (neutral), or completely extended (external) and secure it to the shorter support to provide stability to the outstretched arm. **See Image 13**

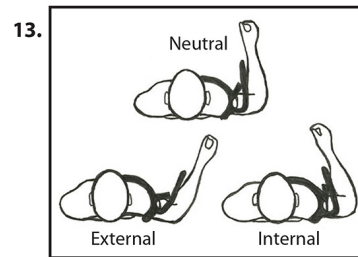

### Adjust Abduction of the Rigid Device

Abduction (movement away from the body) can be modified by increasing the distance between the bendable torso portion and the sling pocket. Creating a wider curve can add to the abduction angle. Once the desired abduction is achieved secure the shorter support to the undersurface of the longer support to prevent it from collapsing towards the waist. **See Image 14**



#### Use and Care:

Hand wash in cold water using mild soap. Rinse thoroughly and air dry. If not rinsed thoroughly, soap residue may cause skin irritation and material breakdown.

Discontinue use if skin irritation occurs and consult your medical professional.

#### Warning:

This product is to be used under the supervision of a medical health professional. This device is not intended for unsupervised public use. If you experience any pain, swelling, sensation changes, or any unusual reactions while wearing this product, consult your medical professional immediately.

#### Warranty:

Thuasne will replace all or part of the brace for defects in material or workmanship for the period of six months from the date of purchase.

#### Caution:

Federal Law (USA) restricts this device for sale by or on the order of a licensed healthcare professional.